

DWG. No. : KP-DFD-058
SHEET No. : 1 of 1

ALL DIMENSIONS ARE IN mm

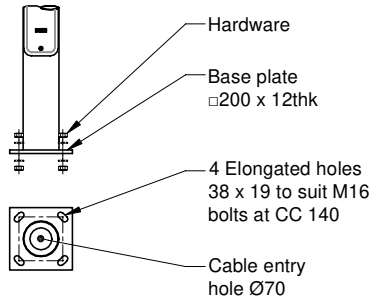

Foundation type	Horizontal level finished "Y"	Coarse sand "Z"
"A" Without base cover	□300	□400
"B" With base cover	□500	□600

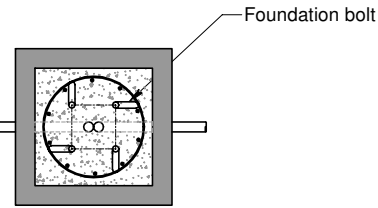
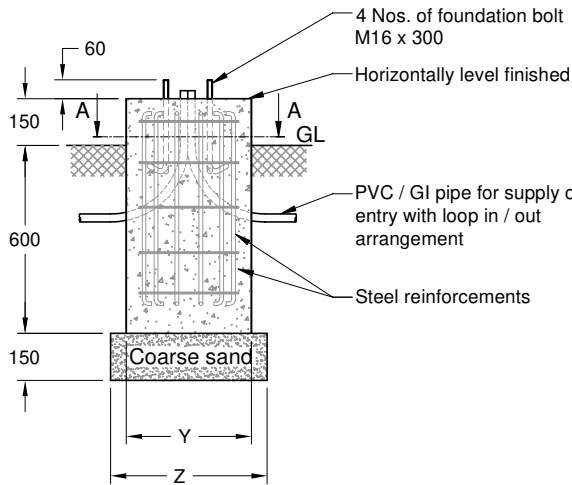

Section: A - A

Note :

1. Typical foundation drawing suitable for standard soil condition.
2. Parameters considered in RCC foundation design:
 Load bearing capacity of soil (LBC) : 10 Mt/m² (Minimum)
 Basic wind speed : 50 m/s
 Grade of steel reinforcement : Fe 415
 Grade of foundation bolt : 4.6
3. Height of foundation above ground level (150mm) may be revised to suit the site conditions especially considering the expected water level stagnation.
4. Template supplied is suggested to be used for locating the CC of foundation bolts.
5. 4 Nos. of foundation bolt have to be oriented (located), while casting the foundation such that the door of the electrical junction box faces the required direction.
6. PVC / GI pipe for entry of supply cable and the materials required for foundation are not scope of our supply.

03.	DESIGN REVISED	06-01-17	M.PALANI		
02.	ELECTRICAL JUNCTION BOX DOOR SIZE REVISED	17-03-16	SELVA		
01.	CABLE ENTRY HOLE, ELECTRICAL JUNCTION BOX DIMENSION REVISED	25-12-15	SATHISH		
REV. No.	REVISION DETAILS	DATE	REVISED	CHD	APPD

DRAWN ARIEF	CHECKED	APPROVED	DATE	SCALE	MATERIAL
			14-10-14	1 : 25	-

\\kfs\CADD SERVER\KP\005.FOUNDATION DETAILS\KP - DFD - 058 (KP-8)\REV 03.dwg

DETAILED FOUNDATION DRAWING FOR KP - 8
□200 x 12 (FOUNDATION BOLT M16 x 300)

K-LITE

K-LITE INDUSTRIES
CHENNAI-600 058

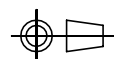

DRG. NO.

KP-DFD-058

REV
03

SHEET
1 of 1