

DWG. No. : KP-DFD-061
SHEET No. : 1 of 1

ALL DIMENSIONS ARE IN mm

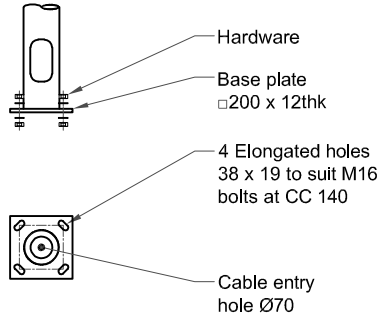

FOUNDATION TYPE	DIMENSION X	POLE HEIGHT
A	600	8' - 10'
B	800	10' - 12'
C	1000	12' - 14'

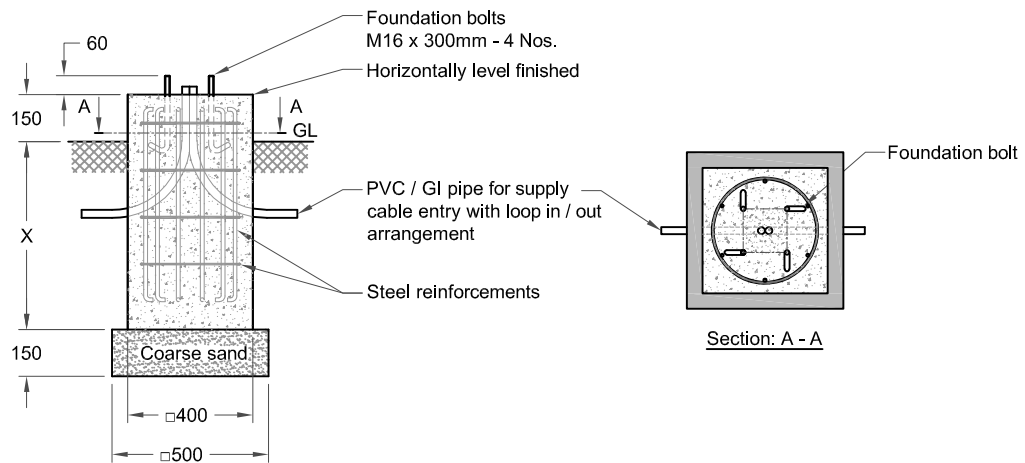

Note

- Typical foundation drawing suitable for standard soil condition.
- Parameters considered in RCC foundation design :
 - Load bearing capacity of soil (LBC) : 10 Mt/m² (Minimum)
 - Basic wind speed : 50 m/s
 - Grade of steel reinforcement : Fe 415
 - Grade of foundation bolt : 4.6
- Height of foundation above ground level (150mm) may be revised to suit the site conditions especially considering the expected water level stagnation.
- Template supplied is suggested to be used for locating the CC of foundation bolts.
- 4 Nos. of foundation bolts have to be oriented (located), while casting the foundation such that the door of the electrical junction box faces the required direction.
- PVC / GI pipe for entry of supply cable and the materials required for foundation are not scope of our supply.

02.	DESIGN REVISED	12-10-18	VIGNESH		
01.	DESIGN REVISED	19-03-18	SATHISH		
REV. No.	REVISION DETAILS	DATE	REVISED	CHD	APPD

DRAWN THIRUPPATHI	CHECKED	APPROVED	DATE 13-12-14	SCALE 1 : 25	MATERIAL -	Z:\KP\005.FOUNDATION DETAILS\KP - DFD - 061 (KP-16)\REV 02.dwg				
		K-LITE INDUSTRIES CHENNAI-600 058			DETAILED FOUNDATION DRAWING FOR KP - 16 □200 x 12 (FOUNDATION BOLT M16 x 300)					
						DRG. NO. KP-DFD-061	REV 02	SHEET 1 of 1		