

"Spectra" pathway luminaire, is an innovative design options to provide visual integration with the environment. Aesthetically designed sturdy construction ensures a long life against all weather condition, maintaining initial performances through the lifetime of the installation. Product offered asymmetrical light distribution.

Product Description

- Luminaire body made of extruded aluminium alloy (grade 6063) and non corrosive stainless steel fasteners.
- Polycarbonate optical lens.
- Luminaire integrated with 50W LED.
- Suitable for mounting on 76mm / 88.9mm OD pipe, 72mm / 91mm square pipe.
- Cable entries for through-wiring of mains supply cable.
- Integral constant current power supply
- CRI (Ra) : ≥ 70
- Prewired with LED driver and suitable for operating on 240V, 50Hz single phase ac supply.
- Ordering guide : KL-4432-CCT (Colour Temperature)
- Available CCT : 3000K, 4000K, 5700K.



Product Benefits

- High luminous efficiency at reduced wattage.
- Functionally versatile, strong and stable.
- Corrosion resistant and Maintenance free.
- Quick installation and low assembly costs.
- Sustainable LED technology offers durability and optimal light output with low power consumption.

Areas of Application

Illuminating parks, Gardens, Commercial complex, Smaller Roadways, Private driveways, Pathways in Residential buildings & office complex.

Available Finish

Pure polyester powder coated

- Graphite grey
- Anthracite grey
- Jet black





Technical Specifications

General

ID	: 4432
System Wattage	: 50W LED
Driver Integral	: Constant Current
Input Voltage	: 230-240Vac
Frequency	: 50-60Hz
Operating Voltage	: 100-265Vac
Operating Temperature	: -15°C~+50°C

Physical

Body	: Extruded Aluminium
Diffuser	: Polycarbonate Optical Lens
Mounting	: Suitable for mounting on Ø76 / Ø88.9 / □72 / □91
Finish	: Powder Coated Graphite Grey / Jet Black Anthracite Grey

Light Source

Light Source	: LUMILEDS / OSRAM
CRI (Ra)	: >70
LED Colour Temperature	: 3000K / 4000K / 5700K

Driver

Power Supply	: Integral
Power Factor	: >0.9
THD	: <10%
Surge Protection	: 6KV
Efficiency	: >85%

Optical Performance

Light Distribution	: Type III
--------------------	------------

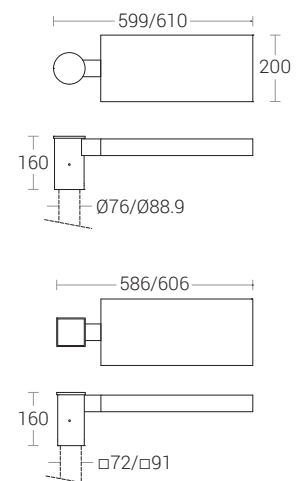

"Spectra" pathway luminaire, is an innovative design options to provide visual integration with the environment. Aesthetically designed sturdy construction ensures a long life against all weather condition, maintaining initial performances through the lifetime of the installation. Product offered asymmetrical light distribution.

Product Description

- Luminaire body made of extruded aluminium alloy (grade 6063) and non corrosive stainless steel fasteners.
- Polycarbonate optical lens.
- Luminaire integrated with 100W LED.
- Suitable for mounting on 76mm / 88.9mm OD pipe, 72mm / 91mm square pipe.
- Cable entries for through-wiring of mains supply cable.
- Integral constant current power supply
- CRI (Ra) : >70
- Prewired with LED driver and suitable for operating on 240V, 50Hz single phase ac supply.
- Ordering guide : KL-4433-CCT (Colour Temperature)
- Available CCT : 3000K, 4000K, 5700K.



Product Benefits

- High luminous efficiency at reduced wattage.
- Functionally versatile, strong and stable.
- Corrosion resistant and Maintenance free.
- Quick installation and low assembly costs.
- Sustainable LED technology offers durability and optimal light output with low power consumption.

Areas of Application

Street Lighting, Park Lighting, Expressways, Highways, Courtyards.

Available Finish

Pure polyester powder coated

- Graphite grey
- Anthracite grey
- Jet black





Technical Specifications

General

ID	: 4433
System Wattage	: 100W LED
Driver Integral	: Constant Current
Input Voltage	: 230-240Vac
Frequency	: 50-60Hz
Operating Voltage	: 100-265Vac
Operating Temperature	: -15°C~+50°C

Physical

Body	: Extruded Aluminium
Diffuser	: Polycarbonate Optical Lens
Mounting	: Suitable for mounting on Ø76 / Ø88.9 / □72 / □91
Finish	: Powder Coated Graphite Grey / Jet Black Anthracite Grey

Light Source

Light Source	: LUMILEDS / OSRAM
CRI (Ra)	: >70
LED Colour Temperature	: 3000K / 4000K / 5700K

Driver

Power Supply	: Integral
Power Factor	: >0.9
THD	: <10%
Surge Protection	: 6KV
Efficiency	: >85%

Optical Performance

Light Distribution	: Type III
--------------------	------------

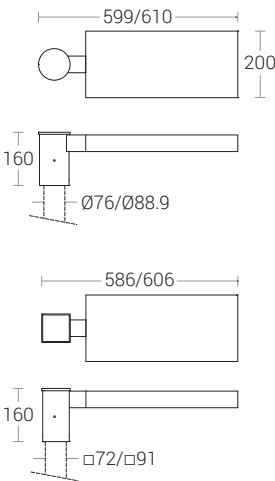

Note : It is our constant endeavor to upgrade the performance of our products. For the latest technical information, IES files and product updates please refer to the website at www.klite.in

"Dual Spectra" pathway luminaire, is an innovative design options to provide visual integration with the environment. Aesthetically designed sturdy construction ensures a long life against all weather condition, maintaining initial performances through the lifetime of the installation. Product offered asymmetrical light distribution.

Product Description

- Luminaire body made of extruded aluminium alloy (grade 6063) and non corrosive stainless steel fasteners.
- Polycarbonate optical lens.
- Luminaire integrated with 100W LED.
- Suitable for mounting on 76mm / 88.9mm OD pipe, 72mm / 91mm square pipe.
- Cable entries for through-wiring of mains supply cable.
- Integral constant current power supply
- CRI (Ra) : >70
- Prewired with LED driver and suitable for operating on 240V, 50Hz single phase ac supply.
- Ordering guide : KL-4434-CCT (Colour Temperature)
- Available CCT : 3000K, 4000K, 5700K.



Product Benefits

- High luminous efficiency at reduced wattage.
- Functionally versatile, strong and stable.
- Corrosion resistant and Maintenance free.
- Quick installation and low assembly costs.
- Sustainable LED technology offers durability and optimal light output with low power consumption.

Areas of Application

Illuminating parks, Gardens, Commercial complex, Smaller Roadways, Private driveways, Pathways in Residential buildings & office complex.

Available Finish

Pure polyester powder coated

- Graphite grey
- Anthracite grey
- Jet black





Technical Specifications

General

ID	: 4434
System Wattage	: 100W LED
Driver Integral	: Constant Current
Input Voltage	: 230-240Vac
Frequency	: 50-60Hz
Operating Voltage	: 100-265Vac
Operating Temperature	: -15°C~+50°C

Physical

Body	: Extruded Aluminium
Diffuser	: Polycarbonate Optical Lens
Mounting	: Suitable for mounting on Ø76 / Ø88.9 / □72 / □91
Finish	: Powder Coated Graphite Grey / Jet Black Anthracite Grey

Light Source

Light Source	: LUMILEDS / OSRAM
CRI (Ra)	: >70
LED Colour Temperature	: 3000K / 4000K / 5700K

Driver

Power Supply	: Integral
Power Factor	: >0.9
THD	: <10%
Surge Protection	: 6KV
Efficiency	: >85%

Optical Performance

Light Distribution	: Type III
--------------------	------------

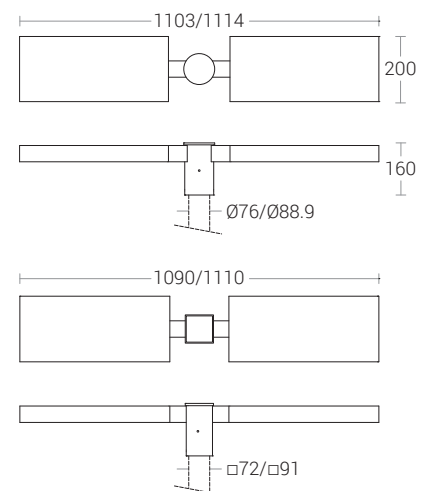

"Dual Spectra" pathway luminaire, is an innovative design options to provide visual integration with the environment. Aesthetically designed sturdy construction ensures a long life against all weather condition, maintaining initial performances through the lifetime of the installation. Product offered asymmetrical light distribution.

Product Description

- Luminaire body made of extruded aluminium alloy (grade 6063) and non corrosive stainless steel fasteners.
- Polycarbonate optical lens.
- Luminaire integrated with 200W LED.
- Suitable for mounting on 76mm / 88.9mm OD pipe, 72mm / 91mm square pipe.
- Cable entries for through-wiring of mains supply cable.
- Integral constant current power supply
- CRI (Ra) : >70
- Prewired with LED driver and suitable for operating on 240V, 50Hz single phase ac supply.
- Ordering guide : KL-4435-CCT (Colour Temperature)
- Available CCT : 3000K, 4000K, 5700K.



Product Benefits

- High luminous efficiency at reduced wattage.
- Functionally versatile, strong and stable with sound engineering.
- Corrosion resistant and Maintenance free.
- Quick installation and low assembly costs.
- Sustainable LED technology offers durability and optimal light output with low power consumption.

Areas of Application

Street Lighting, Park Lighting, Expressways, Highways, Courtyards.

Available Finish

Pure polyester powder coated

- Graphite grey
- Anthracite grey
- Jet black





Technical Specifications

General

ID	: 4435
System Wattage	: 200W LED
Driver Integral	: Constant Current
Input Voltage	: 230-240Vac
Frequency	: 50-60Hz
Operating Voltage	: 100-265Vac
Operating Temperature	: -15°C~+50°C

Physical

Body	: Extruded Aluminium
Diffuser	: Polycarbonate Optical Lens
Mounting	: Suitable for mounting on Ø76 / Ø88.9 / □72 / □91
Finish	: Powder Coated Graphite Grey / Jet Black Anthracite Grey

Light Source

Light Source	: OSRAM / LUMILED
CRI (Ra)	: >70
LED Colour Temperature	: 3000K / 4000K / 5700K

Driver

Power Supply	: Integral
Power Factor	: >0.9
THD	: <10%
Surge Protection	: 6KV
Efficiency	: >85%

Optical Performance

Light Distribution	: Type III
--------------------	------------

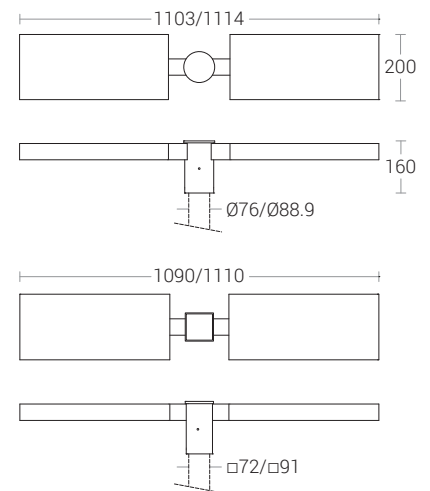

Surface mounted range of LED wall lights are a perfect fit for varied outdoor lighting applications. Designed to illuminate the wall and surface in front of wall and for light accents on vertical surfaces. Aesthetically designed sturdy construction ensures a long life against all weather condition, maintaining initial performances through the lifetime of the installation. Product offered asymmetrical light distribution.

Product Description

- Luminaire body made of rectangular extruded aluminium alloy (grade 6063) and non corrosive stainless steel fasteners.
- Polycarbonate optical lens.
- Luminaire integrated with 50W LED.
- Die cast aluminium base for easy installation onto the wall.
- Surface mounting on wall using hardware after connecting to the power supply.
- Cable entries for through-wiring of mains supply cable.
- Integral constant current power supply
- CRI (Ra) : >70
- Prewired with LED driver and suitable for operating on 240V, 50Hz single phase ac supply.
- Ordering guide : KL-4449-CCT (Colour Temperature)
- Available CCT : 3000K, 4000K, 5700K



Product Benefits

- High luminous efficiency at reduced wattage.
- Functionally versatile, strong and stable.
- Corrosion resistant and Maintenance free.
- Quick installation and low assembly costs.
- Sustainable LED technology offers durability and optimal light output with low power consumption.

Areas of Application

Pathways in Residential buildings, Building facade, Internal passages, Commercial & Business Centers.

Available Finish

Pure polyester powder coated

- Graphite grey
- Anthracite grey
- Jet black





Technical Specifications

General

ID	: 4449
System Wattage	: 50W LED
Driver Integral	: Constant Current
Input Voltage	: 230-240Vac
Frequency	: 50-60Hz
Operating Voltage	: 100-265Vac
Operating Temperature	: -15°C~+50°C

Physical

Body	: Extruded Aluminium
Diffuser	: Polycarbonate Optical Lens
Mounting	: Wall - Surface
Finish	: Powder Coated Graphite Grey / Jet Black Anthracite Grey

Light Source

Light Source	: LUMILEDS / OSRAM
CRI (Ra)	: >70
LED Colour Temperature	: 3000K / 4000K / 5700K

Driver

Power Supply	: Integral
Power Factor	: >0.9
THD	: <15%
Surge Protection	: 6KV
Efficiency	: >85%

Optical Performance

Light Distribution	: Type III
--------------------	------------

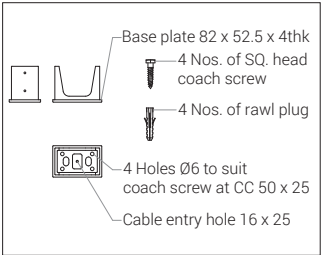
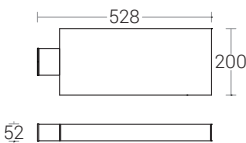

Note : It is our constant endeavor to upgrade the performance of our products. For the latest technical information, IES files and product updates please refer to the website at www.klite.in